

---

ETS/EITS OPEN CEILING  
SOLAR TUNNEL

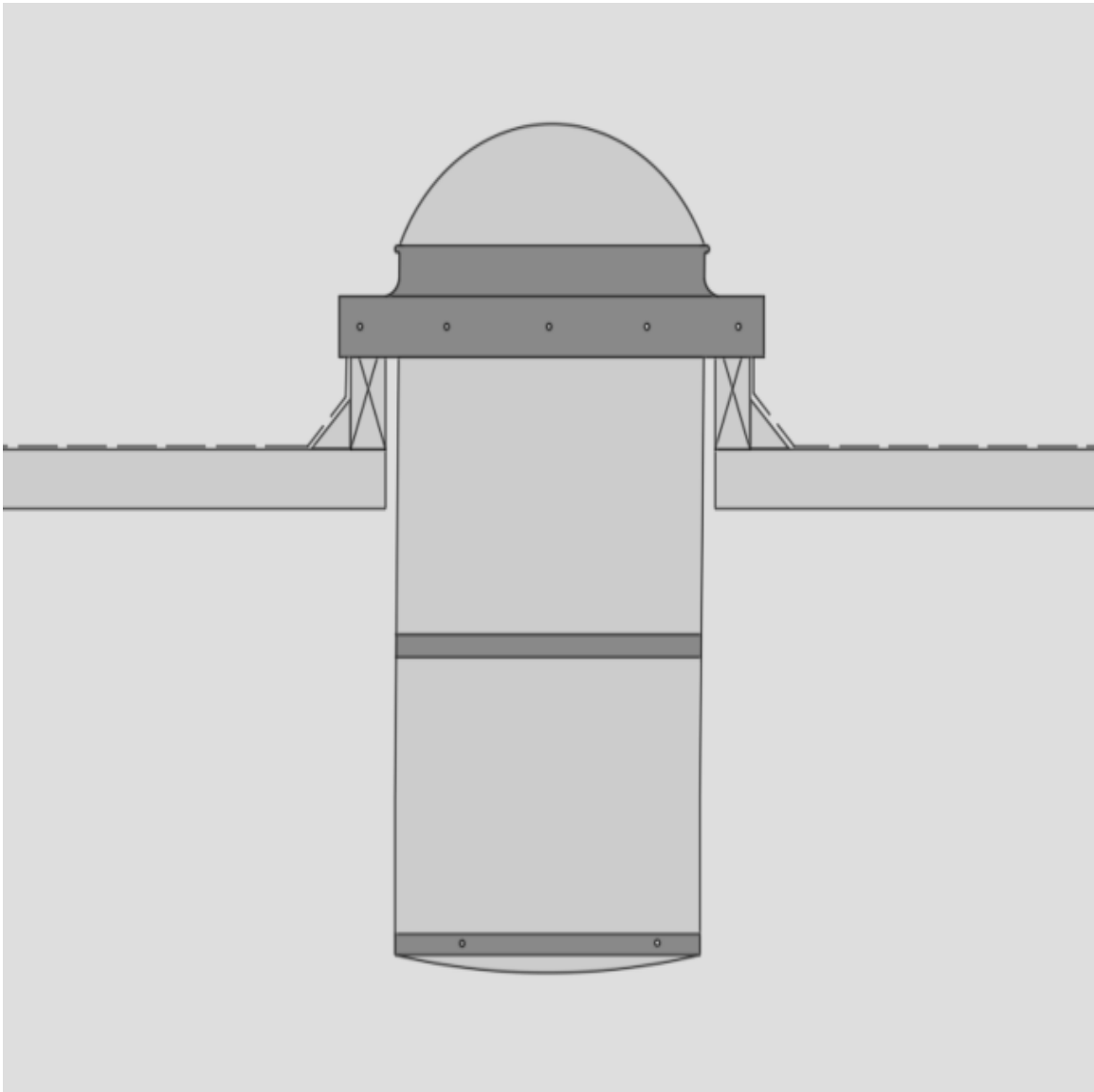

Industrial Solar Tunnel With Curb Flashing  
Installation Guide

PARTS LIST

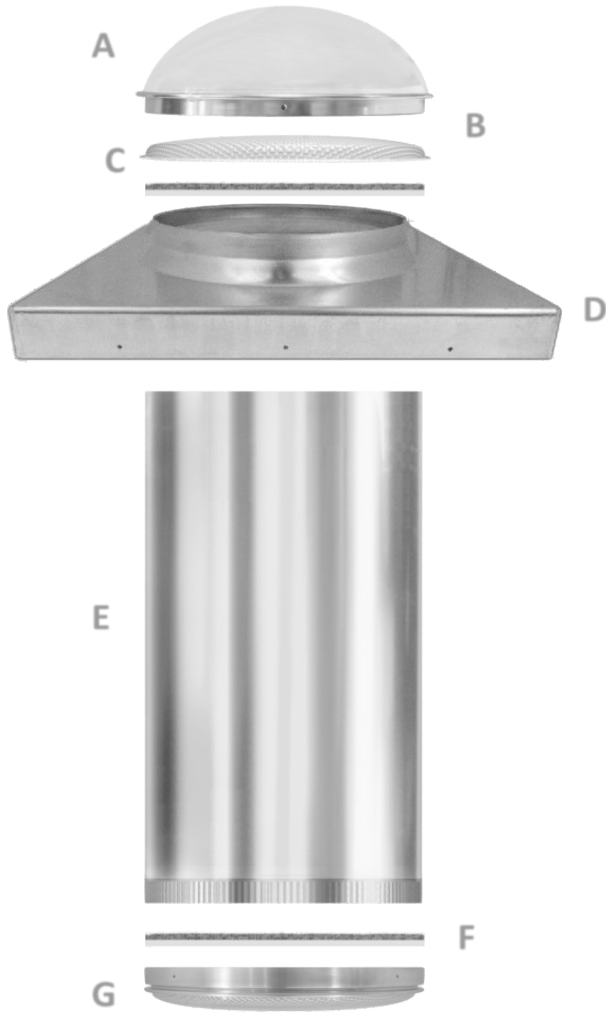

- A. 100% IMPACT ACRYLIC DOME RING w/DUST SEAL
- B. 100% IMPACT ACRYLIC PRISMATIC DOMED SCATTER DISK
- C. DUST SEAL WEATHER STRIPPING w/ 3M SELF ADHESIVE BACKING
- D. .080" SEAMLESS ONE-PIECE ALUMINUM FLASHING
- E. 98.7% ANODIZED ALUMINUM LIGHT TUBE (24" LENGTH SECTIONS)
- F. DUST SEAL WEATHER STRIPPING w/ 3M SELF ADHESIVE BACKING (already applied to inside of Industrial Trim Ring Assembly)
- G. ALUMINUM TRIM RING ASSEMBLY w/POLYCARBONATE DIFFUSER
- H. #8x3/8" STAINLESS STEEL SCREW w/EPDM WASHER (USE #8x3/4" STAINLESS STEEL SCREW w/EPDM WASHER FOR HIGH VELOCITY ZONES)
- I. #8 X 1" SELF TAPPING ZINC PLATED SCREWS
- J. #8 X 2" SELF TAPPING STAINLESS STEEL SCREWS
- K. #8 X 1/2" SELF TAPPING ZINC PLATED SCREWS
- L. ALUMINUM FOIL TAPE

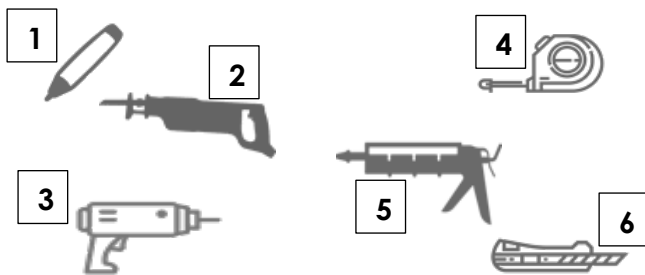

TOOLS NEEDED

- 1. MARKER
- 2. RECIPRICATING SAW
- 3. DRILL GUN w/ #2 PHILIPS BIT
- 4. MEASURING TAPE
- 5. CAULKING GUN
- 6. RAZOR KNIFE OR TIN SNIPS

**IMPORTANT:**

PLEASE READ THE ENTIRE INSTALLATION GUIDE PRIOR TO COMMENCING ANY STEPS. TAKE SAFETY PRECAUTIONS WHEN WALKING ON A ROOF AND WHEN HANDLING MATERIALS, THEY MAY BE SHARP. KEEP LIGHT TUBE INSIDE BOX UNTIL INSTRUCTED TO ASSEMBLE LIGHT TUBE, DO NOT REMOVE LIGHT TUBE FILM UNTIL INSTRUCTED.

1

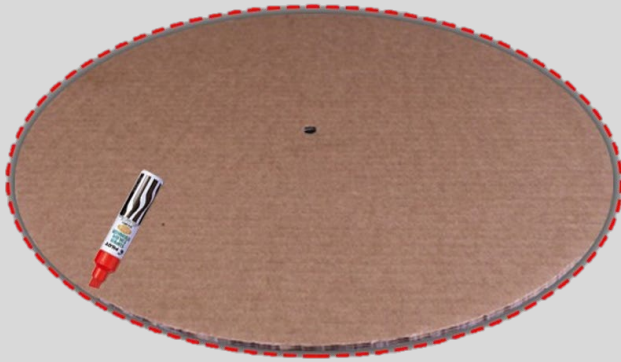

**Step 1:** Locate the desired location on the roof for your new ELITE Tubular Skylight. Make sure there are no obstructions on the inside of the building. With the Flashing Roof Template (provided) trace outside of the template and place a screw in the middle of the traced diameter and wrap a wire or rope on the screw, this will pre-vent the roof cut out from falling inside.  
(BEWARE, DO NOT CUT ANY ROOF TRUSSES)

2

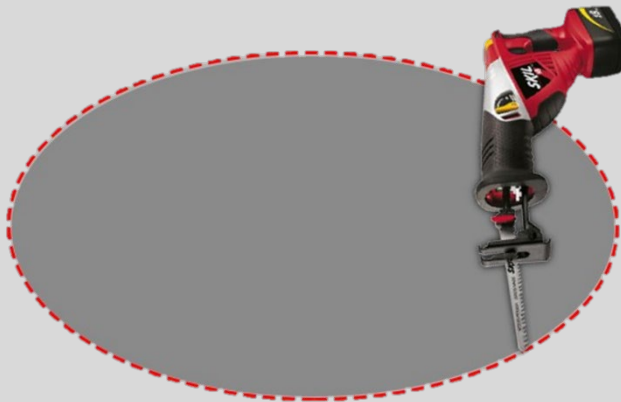

**Step 2:** With a reciprocating saw, cut along the traced line, before completely cutting the hole, grab the screw wire or rope to prevent the piece cut out from dropping inside the building.

3

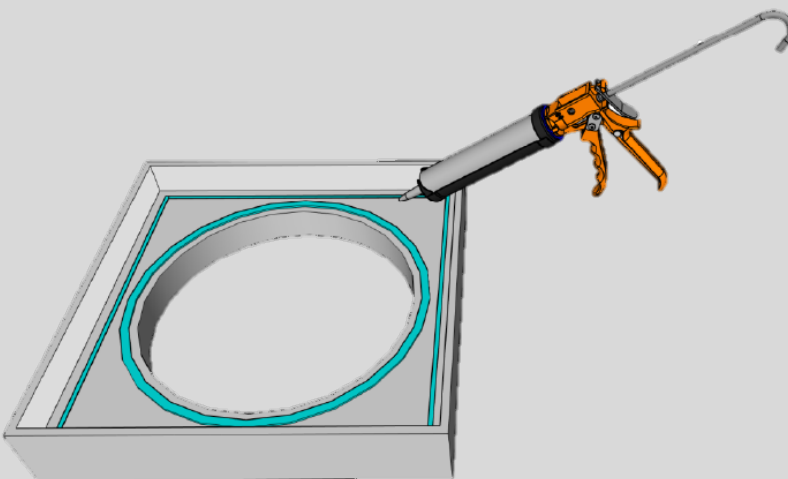

**Step 3:** Flip over the provided Curb Flashing and apply sealant to the underside of the Cap Frame.

4

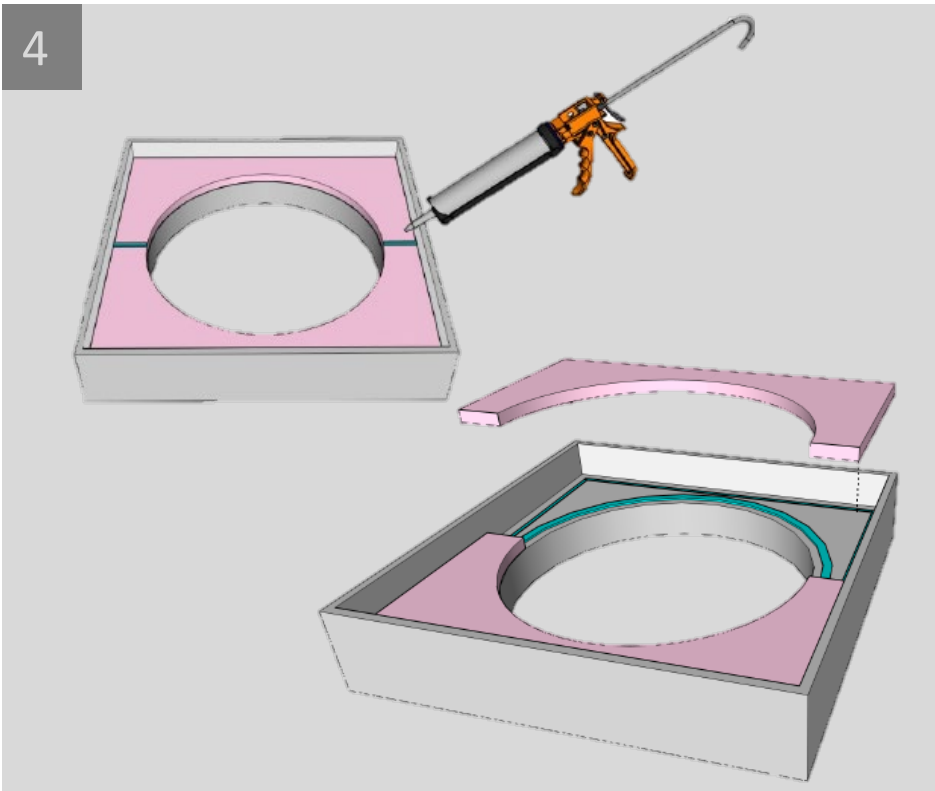

**Step 4:** Cut out 2 pieces of 1/2" rigid insulation (not provided) that forms the shape of the curb flashing. Stick the insulation down and apply 2 lines of a flexible sealant to the seams.

5

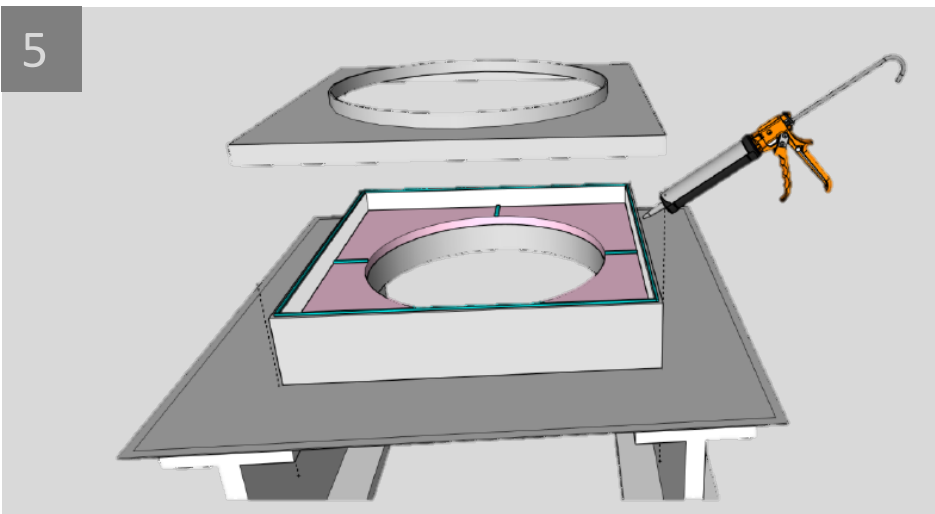

**Step 5:** In order to install a Square Curb Flashing, there should already be a Square Curb built up on the roof. Make sure inside dimensions of Roof Flashing are the same as the outside dimensions of the existing curb structure. Clean the area where the curb flashing will be installed and apply a flexible sealant to the top of the curb to prepare for placing the curb flashing.

6

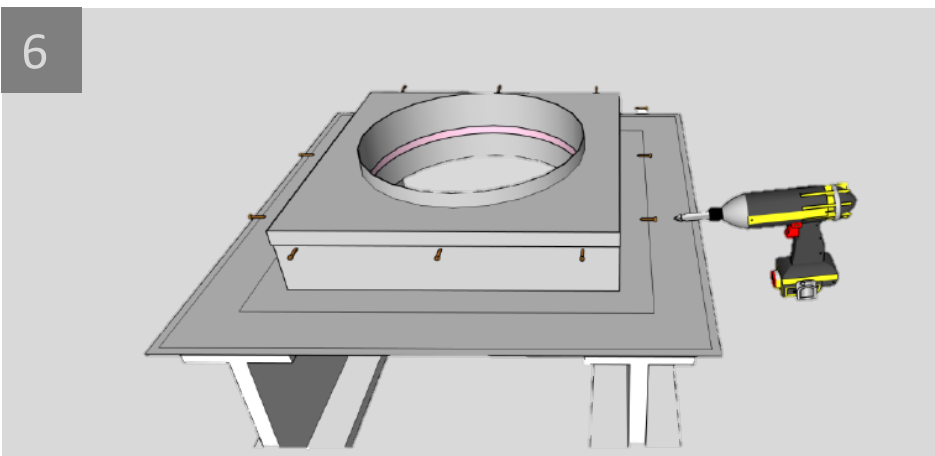

**Step 6:** Place and center Flashing on the existing curb and secure to the curb with 3 (per side) #8x2" Self-Drill screws; on the pre-drilled holes located in the flashing base and apply a flexible sealant on the screw heads. Apply Weather Dust Seal to the inside flange of Flashing towards the top edge.

7

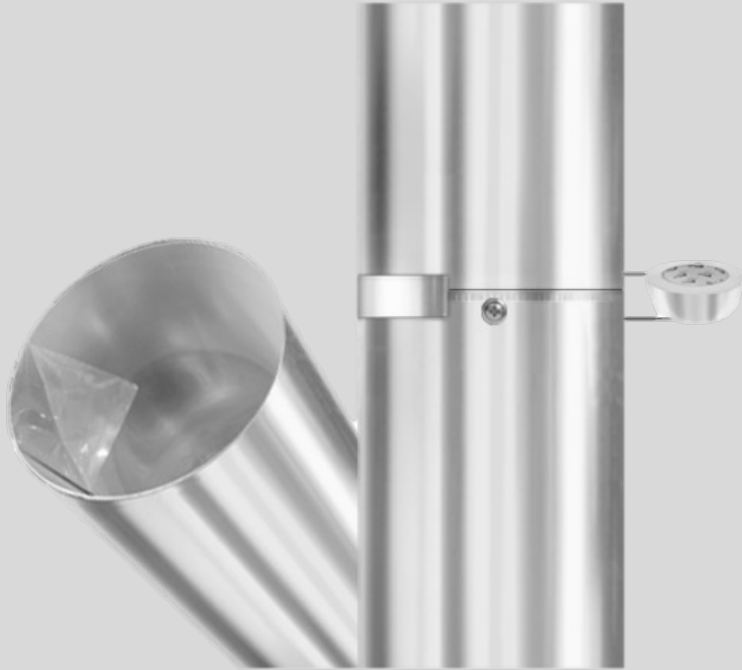

**Step 7:** Assemble the light tube, peel back 2" of protective film from the light tube edge where it will be overlapped at the seam. Remove the liner from the double-sided tape, connect the light tube at the seam and apply pressure on both sides of the light tube (use gloves to prevent getting cut). Place #8x1/2" Self-Drill Screw where the Light Tube over-laps, and place Aluminum Foil Tape over the seam and screw.

If connecting extra light tube together, repeat steps above and remove 2" of protective film where light tube is being inserted to and insert the crimped end of the light tube into the non-crimped end of the other light tube. Place 3 or 4 #8x1/2" Self-Drill screws around where both light tubes are joined together and seal joints with Aluminum Foil Tape.

8

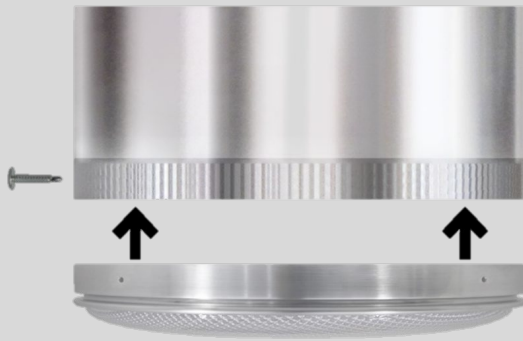

**Step 8:** Insert Industrial Trim Ring Assembly into the crimped end of light tube, secure using #8x1" Self-Drill screws on the pre-drilled holes. Seal joint between the Industrial Trim Ring Assembly and Light Tube with Aluminum Foil Tape.

9

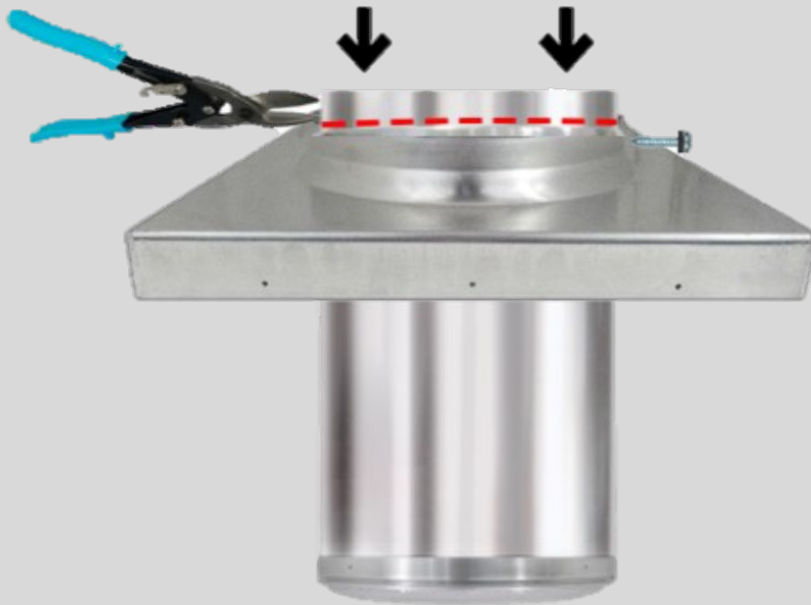

**Step 9:** Insert the Light Tube with the Industrial Trim Ring Assembly facing down through the flashing and secure the Light Tube to flashing by placing (4) #8x1" Self-Drill Screws from the outside of the Flashing top flange and through onto the Light Tube. If aligning is needed, first place (2) #8x1" Self-Drill Screws on Flashing top flange on opposite ends and angle as needed, place the other (2) #8x1" Self-Drill Screws to completely secure the Light Tube to the Flashing. To prevent the Light Tube from falling through the Flashing, have someone else hold the Light Tube while aligning and securing it to the Flashing.

(NOTE: If installing the Tubular Skylight with an Industrial Ceiling Flange, you will need to secure the Light Tube to the Flashing. Inside the building you will insert and secure the Industrial Ceiling Flange to the Light Tube or Ceiling by using (4) #8x 1/2" Self-Drill Screws and seal joints with Aluminum Foil Tape and insert the Industrial Trim Ring Assembly to the Light Tube.)

10

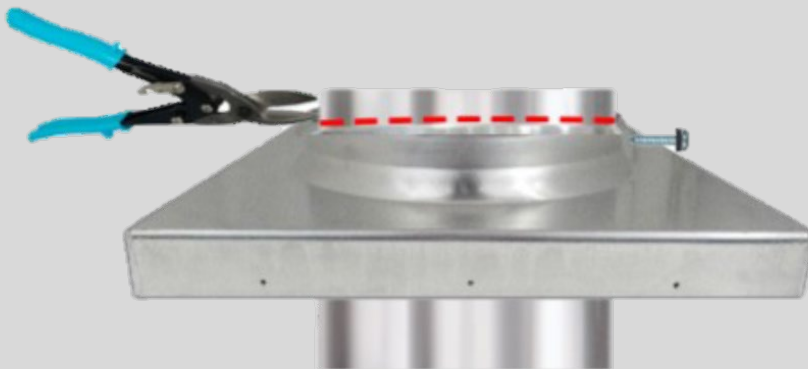

**Step 10:** If there is excess Light Tube sticking out of the Flashing flange, trace outside of the Light Tube by using a utility knife on the top flange of the Flashing, grab one side of the Light Tube and pull towards you to start removing excess Light Tube. You may now remove all protective film from inside Light Tube.

11

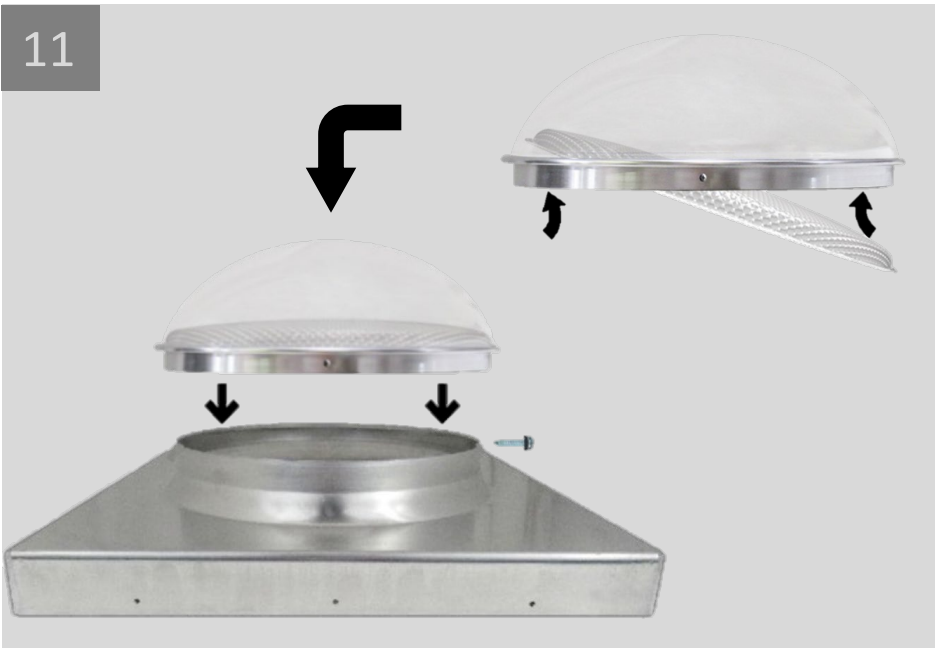

**Step 11:** Insert the Light Scatter Disk into the Dome Assembly and place over the Flashing flange and secure by using #8x3/8" (use #8x3/4" for High Velocity Zones) Sheet Metal Screws with EPDM Washer on the pre-drilled holes on the Dome Assembly. **DO NOT** apply any silicone or sealant between the Dome Assembly and Flashing, doing so will cause any condensation build up to drip inside of Tubular Skylight or building.



Need more information or technical support?  
**Our team is ready to help!**



[artisticskylight.com](http://artisticskylight.com)  
[info@artisticskylight.com](mailto:info@artisticskylight.com)



toll: 1.866.878.3663  
tel: 416.747.7233  
fax: 416.747.6630



255 Regina Rd.  
Woodbridge, ON.  
L4L 8M3, Canada

